



- Lord Street 
- Foreshore 
- Tregea Street 
- Morris Street 
- Old Great Ocean Road 



PARKING BAY COUNT	Type	Proposed	Existing
Tregea Street	Managed - Mixed	71 (3A)	53 (1A)
Cairns Street Foreshore	Managed - Short term	40 (2A)	41 (2A)
Lord Street	Managed - Short term	75 (4A)	85 (3A)
Fishermans Car Park bays	All day	32	32
Baptist Church Council Car Park	All day	34	34
Trail (Old Great Ocean Road)	All day	20	0
TOTAL PARKING BAYS		272	245

**A = Accessible parking*

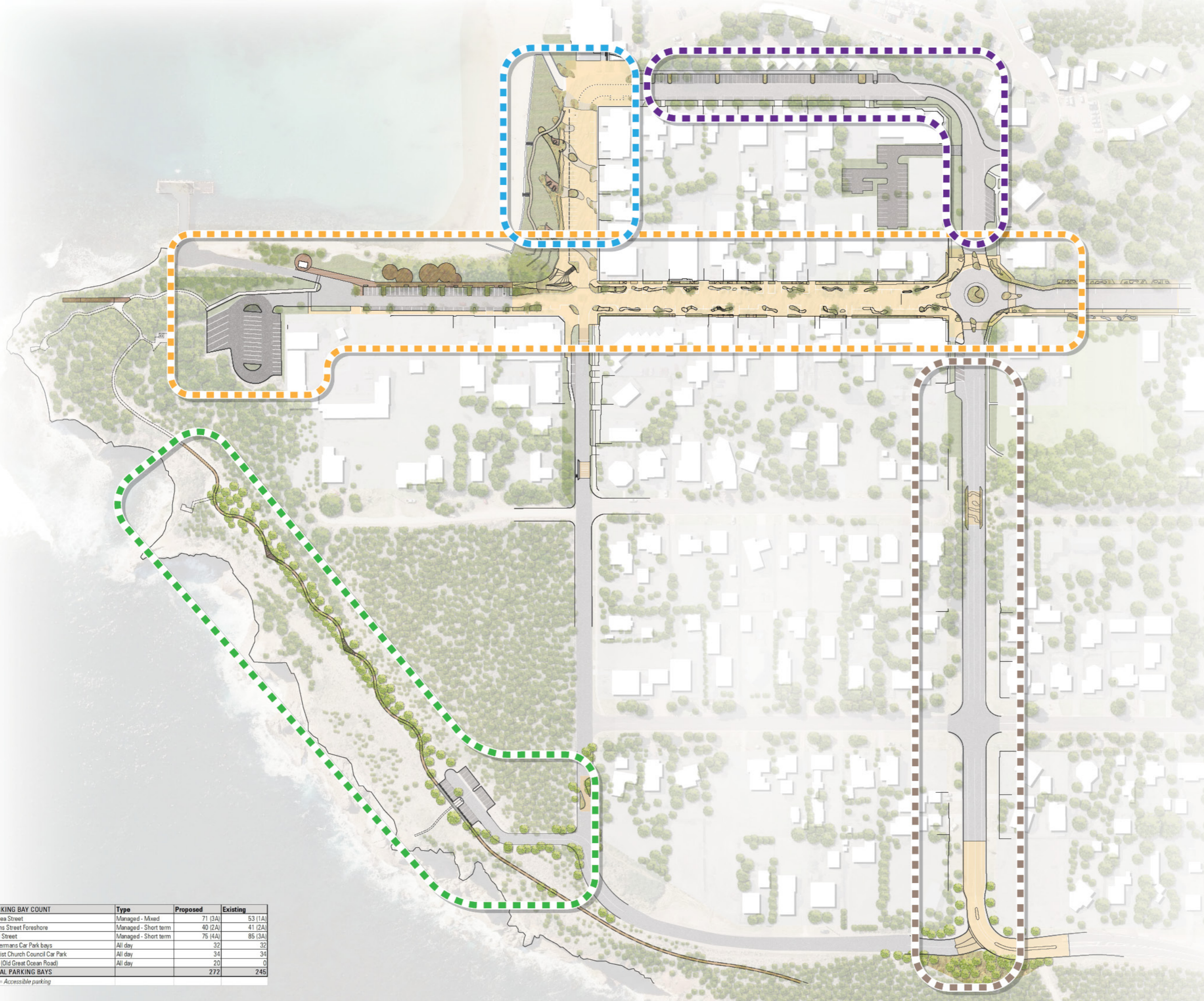
PORT CAMPBELL TOWNSHIP REVISION

Overall plan

